

SKETCH DESIGNS

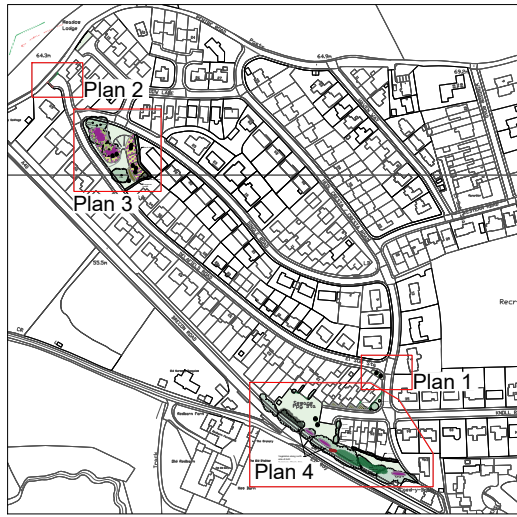

Key Plan

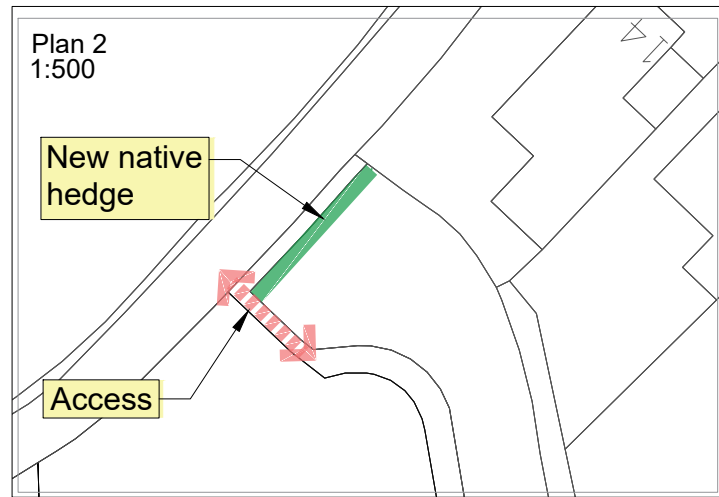

Coppice (cut back) Dogwood by 30% every 3 years

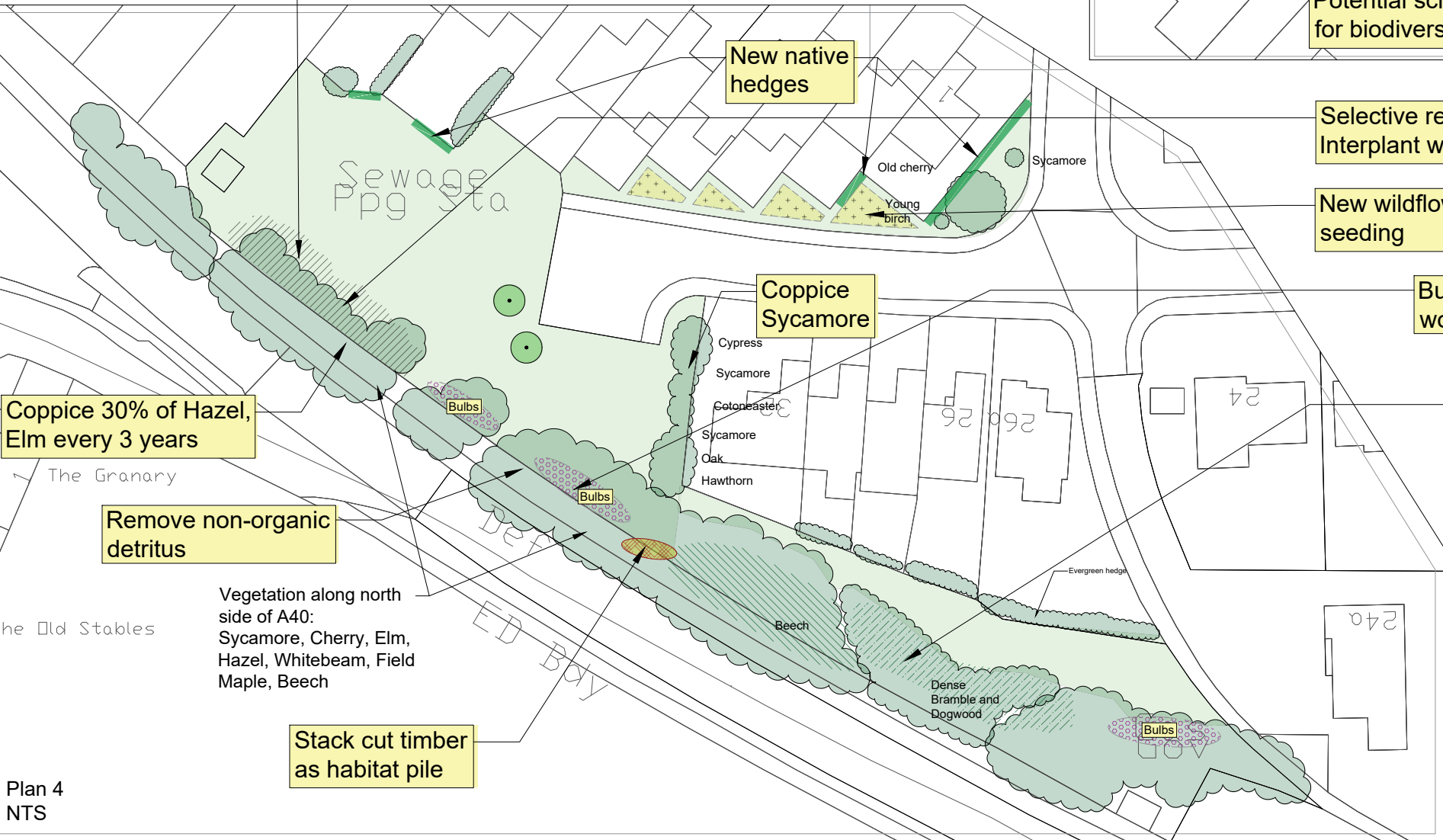

New native hedges

Coppice Sycamore

Coppice 30% of Hazel, Elm every 3 years

Remove non-organic detritus

Vegetation along north side of A40:
Sycamore, Cherry, Elm, Hazel, Whitebeam, Field Maple, Beech

Stack cut timber as habitat pile

Selective removal of Sycamore. Interplant with Beech and Field Maple

New wildflower seeding

Bulb planting area and generally woodland bulbs

Selective coppicing / cutting back Bramble etc understorey 30% every year

KEY:

- Existing vegetation
- New trees
- New native hedge
- Tidy mown grass
- Manage existing sward
- New wildflower areas
- New areas of wildflower turf
- New scrapes for biodiversity
- Bulbs
- New habitat piles
- Pedestrian routes



DRAFT

HAIRE LANDSCAPE CONSULTANTS
 UPPER BRECHFA LLANDEFALLE
 BRECON POWYS LD3 0NG
 Tel. 01874 754066
 Email: mike@hairelandscapeconsultants.co.uk
 Website: hairelandscapeconsultants.co.uk

Monmouthshire County Council
 Client: Green Corridor Habitat Enhancement Projects: Gwent Green Grid
 Project name: Abergavenny Delafield Rd /Dingle Road, Knoll Rd/ Cresta Rd
 Drawing title:
 Scale: 1:500@A3 Date: Mar '24 Drawn by: KH
 Drawing no. **742.03**